

**Series 4, Built-in oven, 60 x 60 cm,  
White  
HBS534BW0B**



**Included accessories**

2 x combination grid  
1 x universal pan  
2 x Universal pan  
slim size

**Optional accessories**

HEZ530000 : Half tray  
HEZ531010 : Baking tray, non-stick ceramic coated  
HEZ538000 : 1fold telescopic rail, level independent  
HEZ634000 : Baking and roasting grid (standard)  
HEZ636000 : Glass pan  
HEZ638300 : 3 level telescopic rails, full ext  
HEZ915003 : Glass roasting dish, 5,4 L

**The built-in oven with 3D hot air: achieve  
perfect baking and roasting results on up to  
three levels simultaneously.**

- **Red LED display control:** easy-to-use thanks to the time functions.
- **Pop-out controls:** Make the front of the oven easy to clean and give it a sleek look.
- **EcoClean Direct:** less cleaning effort thanks to a special coating of the rear wall that automatically absorbs grime.
- **Cleaning Assistance:** less cleaning effort thanks to the new cleaning option, which can be especially used for cleaning of light soiling.
- **2 universal pans, slim size:** optimized for smaller amounts of different dishes.

**Technical Data**

Color / Material Front : White  
Construction type : Built-in  
Integrated Cleaning system : Catalytic partial, Hydrolytic  
Min. required niche size for installation (HxWxD) : 585-595 x 560-568 x 550 mm  
Dimensions : 595 x 594 x 548 mm  
Dimensions of the packed product (HxWxD) : 675 x 690 x 660 mm  
Control Panel Material : Glass  
Door Material : Glass  
Net weight : 33.5 kg  
Usable volume of cavity : 71 l  
First cavity material : Other  
Oven control : mechanical  
Number of interior lights : 1  
Length of electrical supply cord : 120 cm  
EAN code : 4242005057382  
Number of cavities (2010/30/EC) : 1  
Energy efficiency rating : A  
Energy consumption per cycle conventional (2010/30/EC) : 0.97 kWh/cycle  
Energy consumption per cycle forced air convection (2010/30/EC) : 0.81 kWh/cycle  
Energy efficiency index (2010/30/EC) : 95.3 %  
Connection rating : 2990 W  
Fuse protection : 13 A  
Voltage : 220-240 V  
Frequency : 60; 50 Hz  
Plug type : no plug (electrical connection by electrician)  
Included accessories : 2 x combination grid, 1 x universal pan, 2 x Universal pan, slim size



## **Series 4, Built-in oven, 60 x 60 cm, White HBS534BW0B**

**The built-in oven with 3D hot air: achieve perfect baking and roasting results on up to three levels simultaneously.**

---

### **Design**

- LED-Display Control (Red)
- Rotary dial, Retractable control dials, round
- Straight bar handle

### **Features**

- Control panel lock
- Heating-up indicator  
Automatic start
- Electronic clock timer
- Interior halogen light
- 5 shelf positions
- Integral cooling fan

### **Cleaning**

- EcoClean Direct : back panel

### **Programmes/functions**

- Oven with 7 PC heating methods: 3D Hotair, conventional top and bottom heat, Hotair grilling, full width variable grill, pizza function, bottom heat, Hotair gentle
- Fast pre-heating function

### **Accessories**

- 1 x universal pan, 2 x combination grid, 2 x Universal pan, slim size

### **Performance/technical information**

- Energy efficiency rating (acc. EU Nr. 65/2014): A  
Energy consumption per cycle in conventional mode: 0.97 kWh  
Energy consumption per cycle in fan-forced convection mode: 0.81 kWh  
Number of cavities: Main cavity Heat source: electrical Cavity volume: 71 litre capacity
- 120 cm Cable length
- Total connected load electric: 2.99 KW
- Nominal voltage: 220 - 240 V
- Temperature range 50 °C - 275 °C
- Appliance dimension (h x w x d): 595 mm x 594 mm x 548 mm
- Niche dimension (h x w x d): 585 mm - 595 mm x 560 mm - 568 mm x 550 mm
- Please refer to the dimensions provided in the installation manual

## Series 4, Built-in oven, 60 x 60 cm, White HBS534BW0B

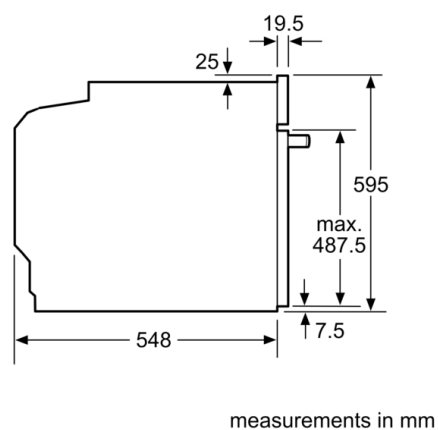
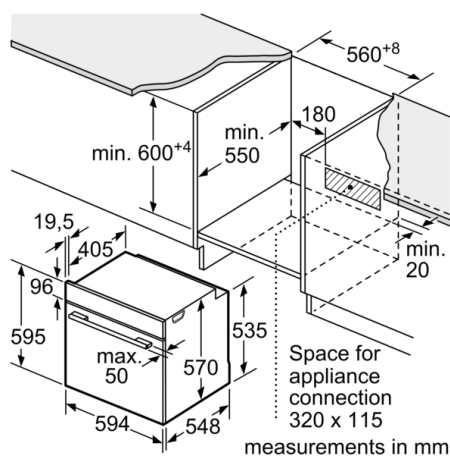

Installation with a hob.

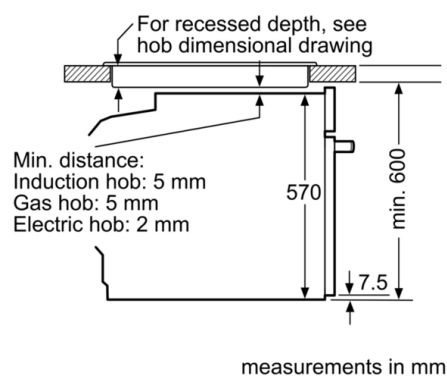

Measurements in mm

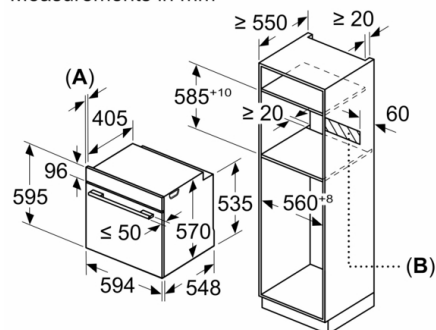

**A:** 19.5 mm  
**B:** Space for appliance connection 320 x 115 mm